

Enter the elegant world of Chelsea Place and discover the gracious, carefree life-style you deserve. After all, you work hard. You need to enjoy life's pleasures in an extraordinary apartment community.

Chelsea Place is picture perfect, from our Georgian clubhouse and stately architecture to our peaceful pond and wooded setting. Our tranquil 52 acres of impeccably landscaped grounds create an exquisite retreat reminiscent of a country estate. Indulge in the great outdoors with our wealth of recreational opportunities. We have three saltwater pools, sand volleyball courts, tennis courts, 24-hour fitness facility, tanning bed, dog



park, fully stocked pond, fitness trails, playground, picnic and barbecue area. We're also just minutes from the finest dining, shopping and entertainment as well as Middle Tennessee State University. You'll be impressed with every aspect of living at Chelsea Place.



Community Map

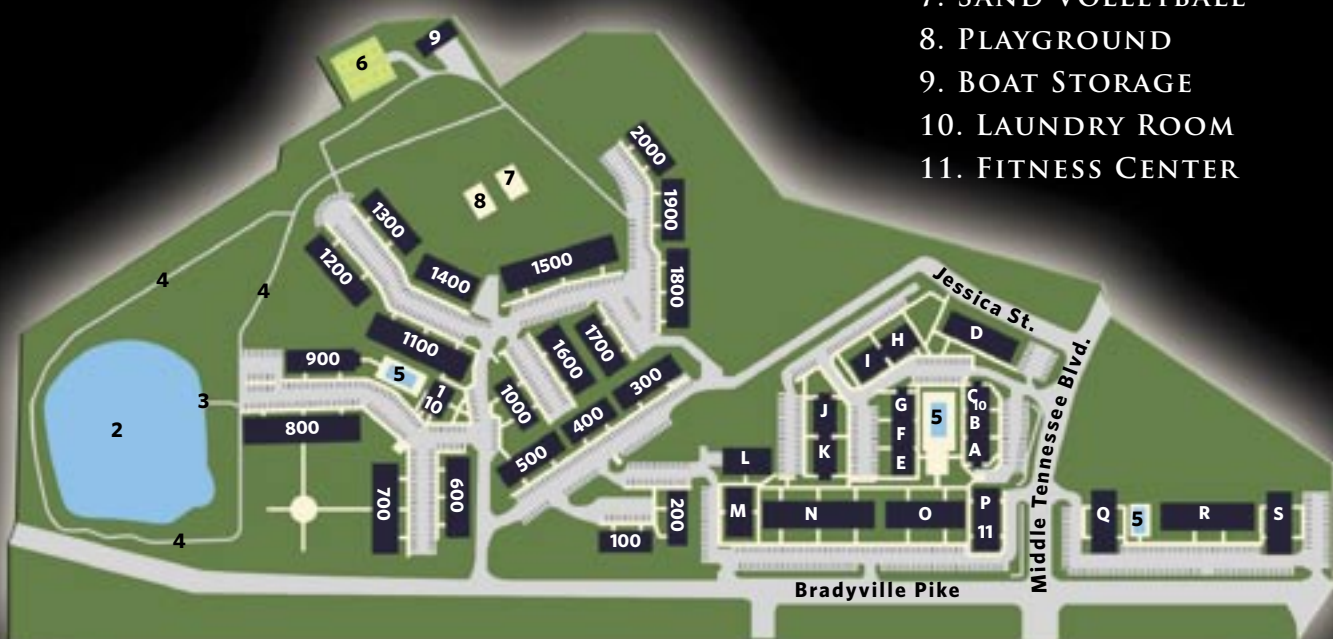

1. INFORMATION CENTER
2. LAKE
3. DOCK
4. WALKING TRAIL
5. POOLS
6. TENNIS COURTS
7. SAND VOLLEYBALL
8. PLAYGROUND
9. BOAT STORAGE
10. LAUNDRY ROOM
11. FITNESS CENTER

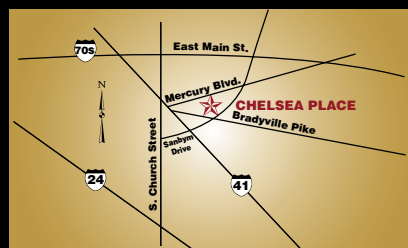

805 BRADYVILLE PIKE
 MURFREESBORO, TN 37130
 615.893.3516 · FAX 615.893.3520
chelseaplaceapts@firstmanagement.net

place for business card

Community Amenities

- 3 Refreshing Salt Water Swimming Pools
- 2 Lighted Tennis Courts
- Fitness Center
- Sand Volleyball Court
- Playground
- Picnic and Barbecue Area in Park-like Setting
- Fully Stocked Pond
- Tanning Bed
- Boat Storage Area
- Clothes Care Centers
- Fitness Trail
- Fax Machine
- One Mile from MTSU
- Two Blocks from Broad Street



Interior Amenities

- Washer and Dryer Connections*
- Dishwasher*
- Individually Controlled Central Heat and Air Conditioning*
- Abundant Closet Space
- Wall-To-Wall Carpeting
- Mini Blinds
- Private Balcony or Patio*
- Fireplaces*



*Available in select floor plans



APPLICATION FEE	\$ _____
CLEANING FEE	\$ _____
SECURITY DEPOSIT (REF.)	\$ _____
SURE DEPOSIT (NON-REF.)	\$ _____
PET FEE*	\$ _____
PET RENT	\$ _____

*BREED AND WEIGHT RESTRICTIONS APPLY

All square footages are approximate for units shown
Prices subject to change without notice

The Williamsburg

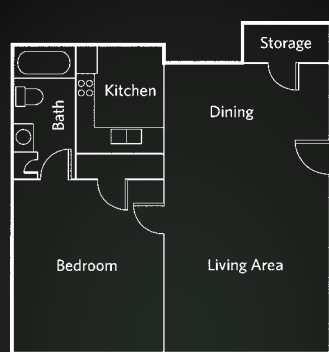

ONE BEDROOM / ONE BATH
444 SQ. FT. / 498 SQ. FT.

\$ _____

The Jackson

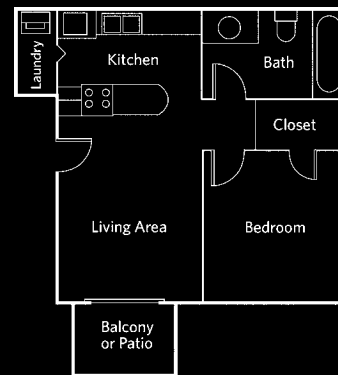

ONE BEDROOM / ONE BATH
483 SQ. FT.

\$ _____

The Lexington

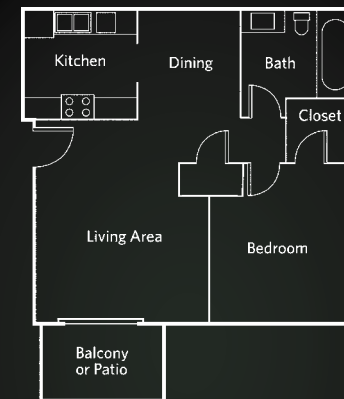

ONE BEDROOM / ONE BATH
676 SQ. FT.

\$ _____

The Raleigh



ONE BEDROOM DELUXE / ONE BATH
712 SQ. FT.

\$ _____

The Augusta



ONE BEDROOM DELUXE / ONE BATH
721 SQ. FT.

\$ _____

The Charlotte

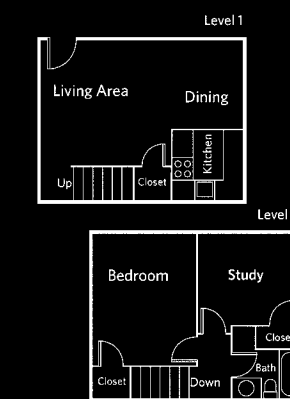

ONE BEDROOM WITH STUDY
TOWNHOUSE 638 SQ. FT.

\$ _____

The Louisville

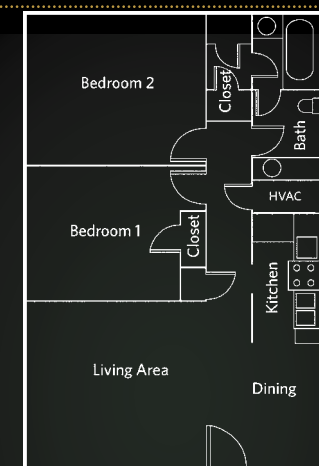

TWO BEDROOM / HOLLYWOOD BATH
883 SQ. FT.

\$ _____

The Savannah



TWO BEDROOM / ONE BATH
721 SQ. FT. / 810 SQ. FT.

\$ _____

The Wilmington



TWO BEDROOM / ONE + 1/2 BATH
987 SQ. FT.

\$ _____

The Charleston

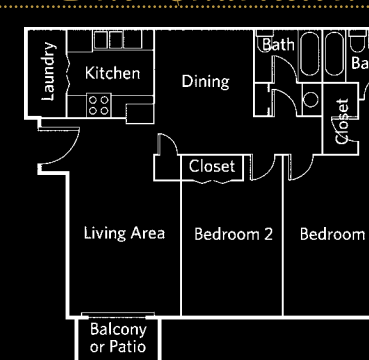

TWO BEDROOM / TWO BATH DELUXE
100 SQ. FT. / 1157 SQ. FT.

\$ _____

The Richmond



THREE BEDROOM / TWO BATH
1345 SQ. FT.

\$ _____